

Spectralink IP-DECT Server 400



On-site DECT Mobility for Small and Medium-Sized Sites

Spectralink IP-DECT Server 400 offers a scalable DECT mobility solution that can grow with your business needs. The IP-DECT Server 400 supports up to 60 handsets/users and up to 24 simultaneous calls. This scalability ensures that the IP-DECT Server 400 solution can grow with your business to fit your exact needs, making it a future-proof solution for small- to medium-sized sites.

The Spectralink IP-DECT Server 400 has a built-in IP-DECT Base Station with 12 radio channels and can be deployed in either single-cell or a multi-cell configuration. The solution is easy to deploy and install due to extensive provisioning options and intuitive menu structure.

The IP-DECT Server 400 supports Zero-Touch provisioning, easy remote configuration, and scheduled firmware rollout support. When there is a need for coverage of a larger area, up to 19 additional IP-DECT Base Stations can be added providing approximately 15,000 sq.m. depending on interior building environment.

Spectralink IP-DECT Server 400 and each IP-DECT Base Station supports up to three Spectralink DECT Repeaters to increase wireless coverage and the optional Spectralink external antenna*, which is an ideal choice for expanding coverage in normally inaccessible areas such as freezing rooms, long corridors, or outdoor areas.

The IP-DECT Server 400 optionally supports handset sharing - typically required in businesses that require shift workers to use the same DECT handset.

Secure messaging, alerting, alarming and integration with advanced business productivity applications are all possible with Spectralink application partner solutions.

The solution is ideal for empowering staff in retail markets, such as stores, petrol stations, car dealerships, fast-food chains, retail banks, as well as smaller healthcare locations such as clinics, dental or medical offices, pharmacies, and other similar businesses.

*Spectralink external antennas are the only approved antenna for the Spectralink IP-DECT Server 400. Third party, external antennas are not supported and will not work.

Benefits

- Supports up to 60 handsets/users, 24 simultaneous calls, and around 15,000 sq.m. of radio coverage.
- Supports market leading Call Control and Unified Communications (UC/UCaaS) platforms
- Scalable & upgradable as capacity & business needs grow
- Delivers high-quality and secure voice communication
- Increases functionality and business efficiency by integrating with messaging and alarms platforms
- Supports enterprise grade security & management



TECHNOLOGY ALLIANCE PARTNERS

We integrate with multiple calling, unified communications, alarms, alerts and messaging platforms.

For current list, visit our [Technology Alliance Partner site.](#)

Specifications

Call Control Protocol Support

- Session Initiated Protocol (SIP)

Operation And Maintenance

- High-speed Web GUI for administration and maintenance
- HTTP with digest authentication
- HTTPS
- Syslog
- SNMP v2
- VLAN tagging

System Architecture

- The Spectralink IP-DECT Server 400 is both a radio unit and a SIP DECT controller unit to the host SIP Call Control / UC platform. Additionally, it controls and handles the Spectralink IP-DECT Base Stations
- Single-cell configuration:
 - 1 x Spectralink IP-DECT Server 400 and up to 3 x Spectralink DECT Repeaters 12 wireless users / 12 simultaneous calls
- Multi-cell configuration:
 - 1 x Spectralink IP-DECT Server 400, up to 19 x External IP-DECT Base Stations and up to 3 x DECT Repeaters connected on each IP-DECT Server or IP-DECT Base Station.
 - Up to 60 users/24 simultaneous calls
- Spectralink Base Station Capacity:
 - Single-Cell: 12 Channels
 - Multi-Cell: 11 Channels** (Air Sync)

Application Program Interface

- XML-RPC API supporting:
 - Broadcast Messaging
 - Message Service Functions (MSF)
- OAM REST API (AMIE)

Supported Codecs

- G.711 A-law and μ -law
- G.726 (32 Kbps - 4-bit ADPCM)
- G.729

Provisioning

- System Configuration
- User data
- Server firmware (Software Assurance License required)
- Base station firmware (Software Assurance License required)
- Handset firmware (Software Assurance License required)

Enhanced Provisioning

- The unit can be programmed to download its own configuration and user settings as well as handset firmware and then update the handset firmware based on a programmed schedule (e.g., upgrade at 03:00)

Note: Scheduled firmware update to all the handsets is accomplished via SUOTA, providing totally automated firmware rollout support to update IP-DECT Server 400 and all connected Base Stations & handsets

Networking

- 10/100 Mbps ethernet port
- Manual or dynamic host configuration protocol (DHCP)
- Time and date sync using Network Time Protocol (NTP)
- LED status indication

Radio interface

- RF output 20 to 24 dBm at the antenna connection
- Sensitivity: typical -90 dBm measured at antenna connection at BER = 0.001
- Average transmit power: typical 5mW/ch (US) or 10mW/ch. (EU)
- Peak transmit power: typical 125mW (US) or 250mW (EU)
- Typical range:
 - Indoor: 50m distance (150 feet)
 - Open areas: Up to 300m distance (1,000 feet)
 - Full slot DECT radio (12 channels)
- Possible to connect an external antenna for directed radio coverage (Only Spectralink external antenna can be used)

Approvals (Regulatory Standards)

- Radio Equipment Directive 2014/53/EU
- Low Voltage Directive 2014/35/EU (CE)
- FCC 47 CFR Part 15

Safety (Regulatory Standards)

- UL62368-1 CAN/CSA-C22.2 No. 62368-1
- IEC 62368-1
- AS/NZS 62368-1
- EN 62368-1

Note: Please check our [support site](#) for the latest approvals and regulatory compliance.

Benefits continued

- Supports DECT Enhanced Security (Encryption and authentication)
- Supports repeaters & external antenna to expand coverage
- Allows for Automatic Air or LAN (Local Area Network) Sync
- Multi-Cell, supports 20 IP-Base Stations for expanded radio coverage (1 Built-in)
- Multiple IP-DECT Server 400 systems can be managed from one organization account in AMIE for IP-DECT
- Automatic Alarm function to get quick assistance from colleagues
- Supports entire Spectralink DECT handset product portfolio

Environmental Conditions

- Operating temperature: 10° - 40° C (50° - 104° F)
- Storage temperature: -50° - 70° C (-58° - 158° F)
- Relative humidity: between 20% and 80% (non-condensing)
- The equipment is in compliance with the requirements of EU directive 2011/65/EU (ROHS) and 2012/19/EU (WEEE)

Electrical Requirements

- Power over Ethernet (IEEE 802.3af), mode A & B
- PoE Class 1 device
- Typical power consumption: 3W per unit
- External power outlet (power supply must be ordered separately)

Physical Characteristics

- Size: 100 x 100 x 43 mm (3.94 x 3.94 x 1.69 in.)
- Weight: 120 gr. (4.2 oz)
- Grey-white (NCS 0502-Y)
- Wall-mountable, indoor
- The server can be mounted upside down

Interoperability

- For information about supported Call Control / Unified Communications (UC / UCaaS) (PBX and IP-PBX) platforms, visit support.spectralink.com.

** The Spectralink IP-DECT Base Station does have 12 channels, but only 11 can be used when synchronizing over the air.

Spectralink IP-DECT Server 400 Configuration

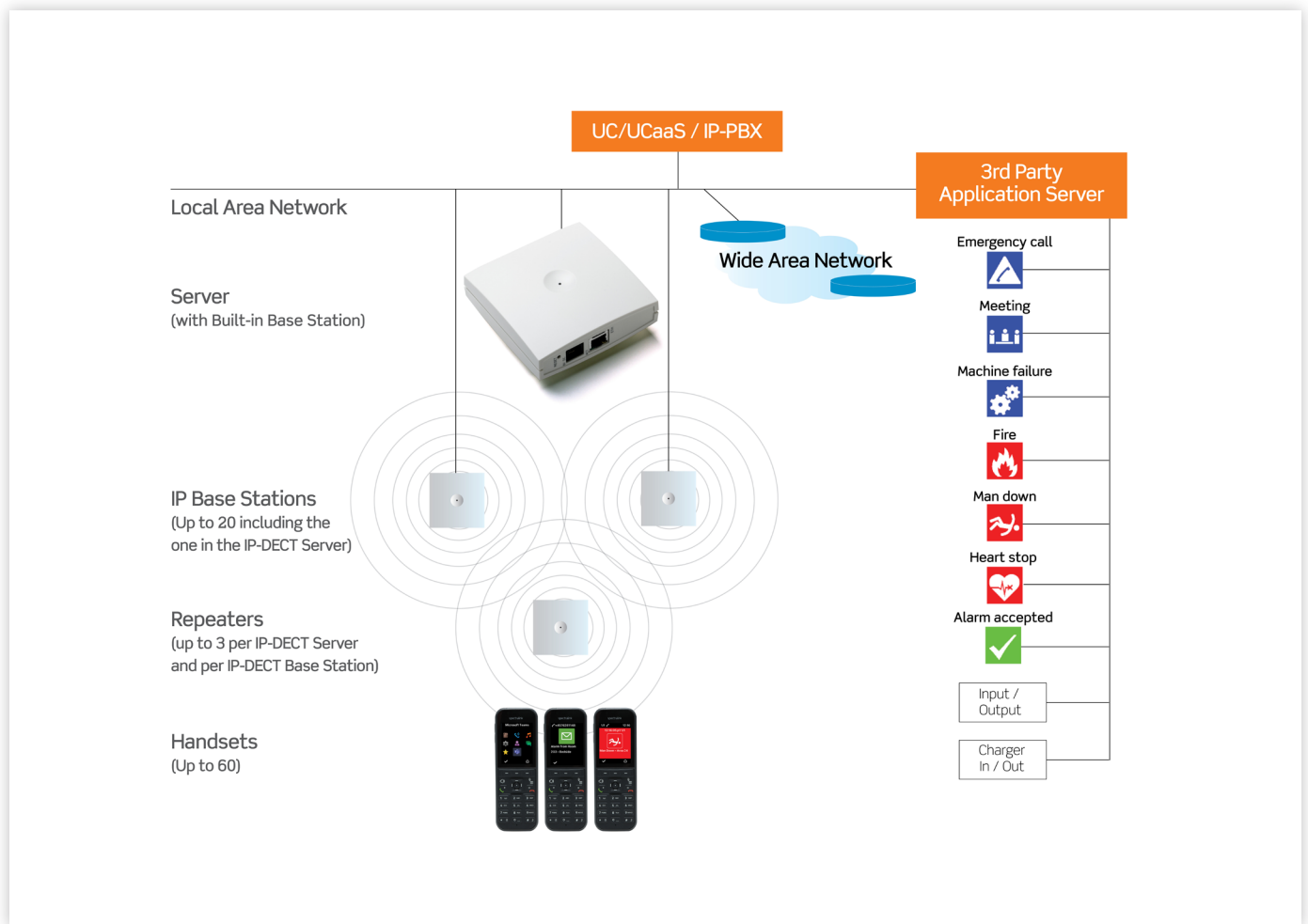

Please get in touch with Spectralink sales to learn about the various 3rd party Application Server-based solutions available from our AIMS ecosystem partners.

About Spectralink

As an award winner in mobile technology, Spectralink has been transforming the way our customers work and communicate for 30+ years. Through our determination to do extraordinary things, we enable mobile workforces and empower our customers and partners to explore what's next, what's possible. With our enterprise grade, best-in-class mobile solutions, we are with our customers wherever they work, however they need us. Our people, commitment to innovation and our passion are our foundation for success.

spectralink.com
 info@spectralink.com
 +1 800-775-5330 North America
 +45 7560 2850 EMEA